

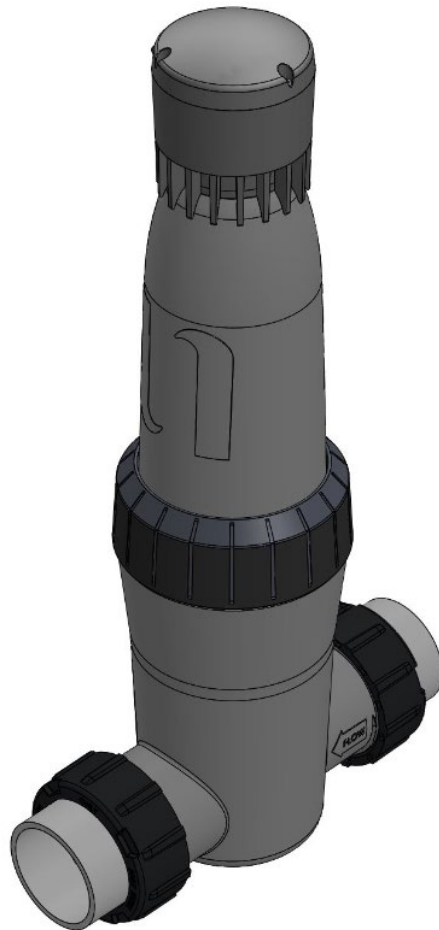

Ui UVC Disinfection System

Installation and Operation Manual



CONGRATULATIONS ON PURCHASING YOUR INSNRG Ui UV Disinfection System

THIS MANUAL HAS BEEN CAREFULLY DEVELOPED TO GIVE YOU ALL THE INFORMATION YOU NEED TO GET THE BEST VALUE FROM YOUR PURCHASE.

It is important that you read through the manual to identify the key areas you need to understand, particularly the following:

- Health and Safety Concerns
- Installation requirements
- How to operate the major features of the unit
- The importance of maintenance
- If you have a problem, what to trouble shoot before you contact your professional
- Finally, your entitlements under your product warranty. Insnrg have developed their product to provide you with the best experience and are sure you will be delighted with your purchase.

Please note: This manual has been designed to cater for installation rules and codes in Australia.

THE IMPORTANT BITS

SECTION 1:

We care about your safety

SECTION 2:

We want you to be delighted

Installing the electronic ballast

Installing the Ui UVC Disinfectant Unit

Water Chemistry

SECTION 3:

Now to have some Fun

Operation

Daily Operation

Water Chemistry

SECTION 4:

Oops, something not right?

Maintenance Plan

Winterisation

Replacement Parts

Warranty

SECTION 1

WE CARE ABOUT YOUR SAFETY



IMPORTANT WARNINGS

Insnrng highly recommend that this product be installed and serviced by professionals who are qualified in pool and spa product installation and service. Improper installation and/or operation can create an unwanted electrical hazard which can cause serious injury, property damage, or death. Improper installation and/or operation will void the warranty.

This manual contains important information about the installation, operation and safe use of this product. This information should be given to the owner/operator of this equipment.

WARNING

This appliance is not intended for use by persons (including children) with reduced physical, sensory or mental capabilities, or lack of experience and knowledge, unless they have been given supervision or instruction concerning use of the appliance by a person responsible for their safety.

WARNING

This chlorinator is to be supplied by an isolating transformer or supplied through a residual current device (RCD) having a rated residual operating current not exceeding 30 mA.

WARNING

If the supply cord is damaged, it must be replaced by the manufacturer, its service agent or similarly qualified persons in order to avoid a hazard.

CAUTION

All components of the filtration system including Pumps, Filters, Heaters must be positioned so as to prevent being used as a means of access to the pool by young children. To reduce risk of injury, do not permit children to use or climb on this product. Closely supervise children at all times.

WARNING - HAZARDOUS PRESSURE

Pool and Spa water circulation systems operate under hazardous pressure during start up, normal operation, and after pump shut off. Stand clear of circulation system equipment during pump start-up. Failure to follow safety and operation instructions could result in violent separation of the pump housing and cover, and/or filter housing and clamp due to pressure in the system, which could cause property damage, severe personal injury, or death. Before servicing pool and spa water circulation systems, all system and pump controls must be in the off position and filter manual relief valve must be in open position. Before starting system pump, all system valves must be set in a position that allows system water to return back to the pool. Do not change filter control valve position whilst system pump is operating. Before starting system pump, fully open filter manual air relief valve. Do not close filter manual air relief valve until a steady stream of water (not air) is discharged.



WARNING - RISK OF ELECTRIC SHOCK

All electrical wiring **MUST** be in conformance with applicable local codes, regulations, and the National Electric Code (NEC). Hazardous voltage can shock, burn, and cause death or serious property damage. To reduce the risk of electric shock, do **NOT** use an extension cord to connect unit to electric supply. Provide a properly located electrical receptacle. Before working on any electrical equipment, turn off power supply to the equipment.



WARNING

To reduce the risk of electric shock replace damaged wiring immediately. Locate conduit to prevent abuse from lawn mowers, hedge trimmers and other equipment.

ELECTRICAL CODES

All electrical work must be performed by a licensed electrician and conform to all national, state and local codes including AS3000 Wiring Rules.

GENERAL SAFETY RULES:

The Insnrg Ui UV Disinfectant system has been designed specifically for residential swimming pool use. Using the product for any other purpose could affect performance, void warranty, and may result in property damage, serious injury or death. Consult your local pool professional if you have any doubts.

The following general guidelines should be followed during installation:

- Always install equipment out of reach of children
- A damaged power supply cable and/or UV light housing should only be replaced by the qualified service agent, electrician or manufacturer.
- When installing and using this electrical equipment, always follow basic safety precautions.
- When preparing to install the Insnrg Ui UVC, disconnect all power to your installation area.
- Ensure you connect to a circuit that is protected by a ground fault circuit interrupter (GFCI)
- The electronic ballast must be installed out of direct rain, sunlight or other sources of water including rain splashback and sprinkler systems.
- To avoid damage due to splash-off, the Ballast must be installed a minimum of 1.5 metres (5 feet) vertically from the ground.

Your Insnrg Ui UVC system is intended for use with permanent swimming pools and may also be used with hot tubs and spas if so marked. Do not use with storable pools.

To reduce the risk of electric shock, fire or injury, service should only be attempted by a qualified pool service professional.

EQUIPMENT UNDER PRESSURE

Always turn pump and other equipment off prior to installing or servicing the Insnrg Ui UVC system. Your filtration system operates under pressure and this pressure must be released before you begin

PREVENT CHILD DROWNING

Do not let anyone, especially small children, sit, step lean or climb on any equipment installed as part of your pool's operational system. Locate the components of your operational system at least 3 metres from the pool so children cannot use the equipment to access the pool and be injured or drown.

This appliance is not intended for use by persons (including children) with reduced physical, sensory or mental capabilities, or lack of experience and knowledge, unless they have been given supervision or instruction concerning use of the appliance by a person responsible for their safety.

We want you to be delighted

INSTALLATION



Disconnect power to all pool equipment before installation

MOUNTING ELECTRONIC BALLAST

The electronic ballast must be mounted under cover out of direct sunlight and rain.

- Mount ballast on a secure base 1 meter above ground level to prevent splash back from rain or when cleaning pool equipment
- Mount ballast so that the power lead can easily reach the Ui UVC installed in the pipe work and the 230 Volt plug can reach the desired GPO
- Ensure the power supply is connected to a GFCI

INSTALLING THE Ui UVC CHAMBER

- The Ui is supplied with barrel unions and 50mm high pressure PVC pipe tails.
- Locate the UVC in the return line to the swimming pool or spa and **BEFORE** other sanitising devices. This will stop any UV light emitting through clear chlorinator cell housings and ensure clear water is flowing past the UV tube to provide maximum penetration of UV light into the water.
- The Ui **MUST** be mounted vertically
- Care should be taken so that the Ui is installed in such a manner that the globe can be removed from the top of the housing. Allow at least 300mm clearance above the top of the Ui for service and maintenance

- Ensure there are no clear PVC or ABS fittings or pipework above ground installed on the inlet of the UI to prevent UV light escaping the unit

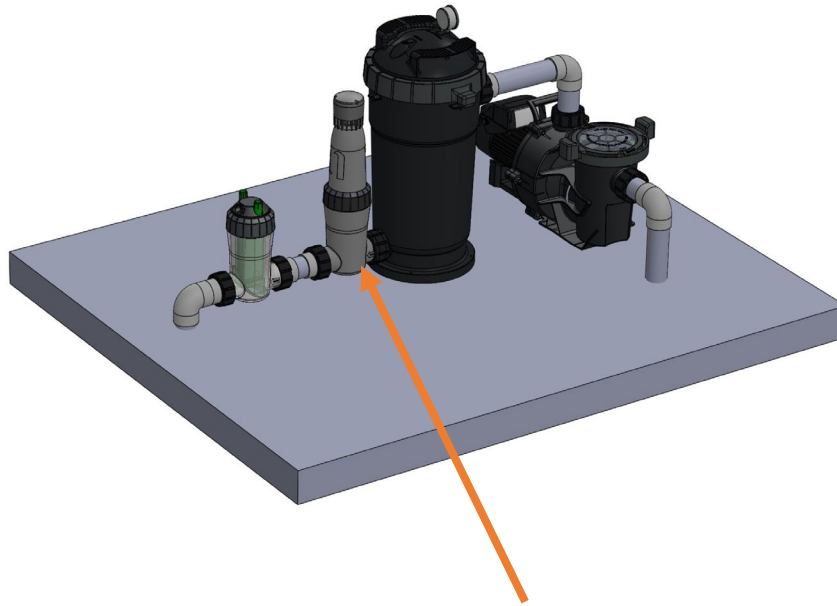

UV installed BEFORE chlorinator cell on return line to pool or spa

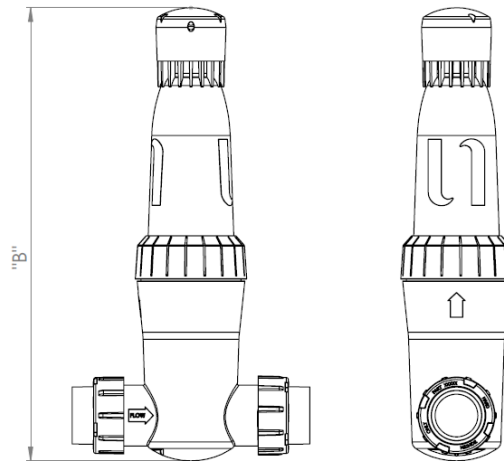
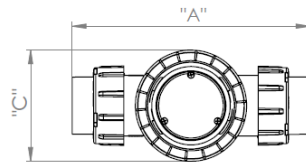

Specifications	Length "A"	Height "B"	Width "C"	Power Consumption	Conns	Flow Rate (lpm)
110 - 240 VAC 50/60 hz	285 mm	545 mm	180 mm	55W	50mm/2"	100 - 300

OPERATION

UVC light is highly effective when the water is clear and has low turbidity. UVC light will inactivate 99.8% of pathogens, viruses and bacteria but will have little effect on algae.

The Ui UVC lamp is a single point sanitizer and will not leave a residual in the swimming pool. It is important that a supplementary sanitizer is installed that creates a residual in the pool or spa to deal with contaminants introduced directly to the water which has not passed through the Ui chamber first.

The Ui should be turned on when the filtration pump is operating and off when the pump is off. Set time clocks so that the Ui operates at the same time as your filter pump and supplementary sanitizer such as a salt chlorinator.

DAILY OPERATION

The life of the Ui UV globe is determined by how many times it is turned on and off. The Ui should only be turned on and off once per day. Therefore, it is highly recommended that the Ui is run concurrently with the filter and chlorinator system for 8 to 10 hours per day in one timer period.

The electronic ballast will indicate on the LED when the UV globe needs replacing. Replacement globes can be purchased from your professional pool retailer or by contacting Insnrg at www.insnrg.com

WATER CHEMISTRY

The Ui will not affect any other water chemistry value such as pH or TA and enables you to run your pool with lower levels of residual chlorine. Chlorine usage may be reduced by as much as 80% which will also lower the quantity of other chemicals you need to add to your swimming pool or spa.

Oops, something not right?

MAINTENANCE PLAN

Your Insnrg Ui UVC Chamber and Ballast are one of the hardest working items in your home. They are designed to withstand harsh outdoor conditions, water flow and weather conditions. Some of these parts will wear in the normal course of use and require regular checks and maintenance. A well thought out pro-active maintenance schedule with identify faults early and extend the lifespan of your Ui.

WHEN	WHAT ARE YOU LOOKING FOR?	HOW CAN YOU FIX IT?
Weekly	Visual confirmation the ballast LED indicator is green	If RED LED showing replace UV lamp
Quarterly	Check all O rings and gaskets for leaks	Isolate power and turn off power to pump and other filtration system components. Contact your pool professional to replace leaking O ring
Weekly	Check Ballast is dry and free of insects, leaves and flooding	Clean around Ballast, turn power off to unit and spray around Ballast with insect surface spray
Quarterly	Quartz Tube requires cleaning	Contact your pool professional to remove quartz tube and clean as necessary – particularly if pool has had algae

WINTERISATION

It is important to protect your Ui from freezing water conditions. As water freezes it expands and that can cause the quartz tube to break or the outer housing to fracture.

In mild climates, when temporary freezing conditions may occur, run your pump and filtering equipment all night to maintain water circulation and prevent freezing.

In freezing conditions are expected take the following steps:

- Shut off electrical power to the pool equipment
- Drain water our of pump and loosing barrel unions of all equipment to drain water

WARRANTY

Insnrng products are designed and manufactured to the highest possible standards of performance.

Australian Consumer Law

Our goods come with guarantees that cannot be excluded under the Australian Consumer Law. You are entitled to a replacement or refund for a major failure and for compensation for any other reasonably foreseeable loss or damage. You are also entitled to have the goods repaired or replaced if the goods fail to be of acceptable quality and the failure does not amount to a major failure.

Warranty Period and Conditions:

Insnrng Techne Pty. Ltd> (herein after “the Company”)

is pleased to warrant to the original retail purchaser that this product shall be free of manufacturing defects for a period of two (2) years from the original invoice date subject to the following conditions:

1. The product is purchased new from an authorised Insnrng dealership in Australia
2. This warranty is not assignable and applies to the original retail purchaser only and the original receipt, invoice or any other proof of purchase must be retained and produced if required by the Company
3. Nothing in this warranty shall apply to any defects caused by misuse or abuse, neglect, accident, extremes of climate, dampness, humidity, reasonable fair wear and tear and/or any causes other than defects in manufacturing and materials. Proper care and maintenance information is detailed in the Owner’s Manual for this product which you must follow.
4. Where a defect is physically visible or otherwise affects the exterior surfaces of the product, you must notify the Company of such defect within fourteen (14) days from the date of your purchase.
5. If the product is bought as a demonstration, refurbished, ex-rental, discontinued or otherwise previously unboxed unit, the warranty applicable shall be limited to 12 months.

Thanks again for purchasing some of our high performance Pool Equipment

We know that you will get many years of enjoyment from this product.

Insrg has been founded by

a team with over 120 years experience in the Pool and Spa industry.

We pride ourselves on developing products that are specifically created for your backyard lifestyle. We are continuously developing new products and ideas to make pool ownership easier and fun.

MAIL

57-59 Nantilla Road,
Clayton, VIC, 3168

LANDLINE

(03) 8578 5633

WEBSITE

www.insrg.com

Should you wish to keep updated with our progress and hear first hand our new products and developments, please feel free to stay in touch by using any or all of the above methods

